

Logset 20'

Revillusion®



The Revillusion® logset 20" by Dimplex is an electric fire system designed to instantly revive your non-active fireplace. Very easy to install, safe, maintenance free, and requiring surprisingly little energy. A great way to bring back the fascination of flames moving upwards from the glowing logs, reinstalling your fireplace as a focal point, for great moments around the fire. Fitted with ambient light functions and a heater and even a remote, to let you enjoy your fireplace comfortably at each moment of the day and year.

USP's

- Freestanding fireplace that is also suitable for inoperative fireplaces as insert
- Adjustable brightness level to suit the desired ambience
- Mirage Flame panel - partially frosted acrylic panel which works better than a mirror, showing only lifelike flames and no reflections
- The 360° light adds flickering light to enhance the firelight effect
- Enjoy the unique charm of the fireplace 365 days a year using the flames without the heat



Article number: 211156 | EAN Code: 5011139211156 | Revillusion®

 **Dimplex**

Disclaimer
We have compiled this publication with the utmost care. The information in this publication can be shown inaccurately, may have been changed or supplemented. This publication can be changed. Glen Dimplex is not responsible for the action taken, decisions of results based solely on the information contained in this publication.

Dimensions

Width: 603 mm
 Height: 482 mm
 Depth: 317 mm
 Weight: 5.0 kg

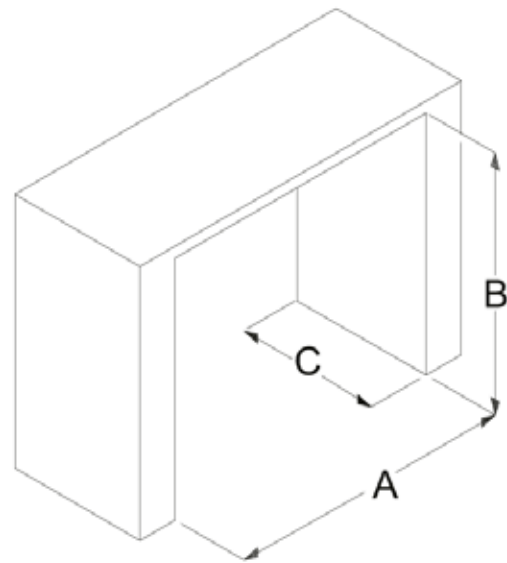

		Log set 20"
General specifications	Fire system	Revillusion®
	Article number	211156
	EAN code	5011139211156
	Model	Insert
	View of the fire	3 sided
	Colour	Black
	Decoration / fuel bed	LED log set
Product size	Measurements view of the fire (WxH)	-
	Outside dimensions WxHxD	60,3 x 48,2 x 31,7 cm
Features	Heat output	Yes
	Thermostat	Yes
	Remote control	Yes
	Manual controlling directly at the fireplace possible yes / no	Only flame effect
	Light module	LED
	Sound module	No
	Colour effects settings	No
Power consumption	Heat setting 1 in W	650W
	Heat setting 2 in W	1300W
	Flame only operation in W	9W
	Max. consumption	1300W
Voltage	Voltage/Electrical frequency	230V/50Hz
Specifications	Product weight in kg	4,9
	Length of the cord	1,5 m
	Warranty	2 year