

Nissum

This frame for the Wall fire engine is available in realistic Concrete look or high-gloss black, to give your fireplace a modern, striking, sleek or industrial look. Also available as the larger Nissum L.

Note: The Nissum is only the frame to be mounted on the Wall Fire engine, the engine itself is not included.

USP's

- Wall-mounted surround in a stylish and refined design
- Modern and industrial concrete look
- Excluding engine, this surround requires the Wall fire engine S or L



Nissum concrete S
207821 / 5011139207821



Nissum concrete L
207838 / 5011139207838

Required engine



Nissum Concrete S
Wall fire engine S
210180
5011139210180



Nissum Concrete L
Wall fire engine L
210203
5011139210203

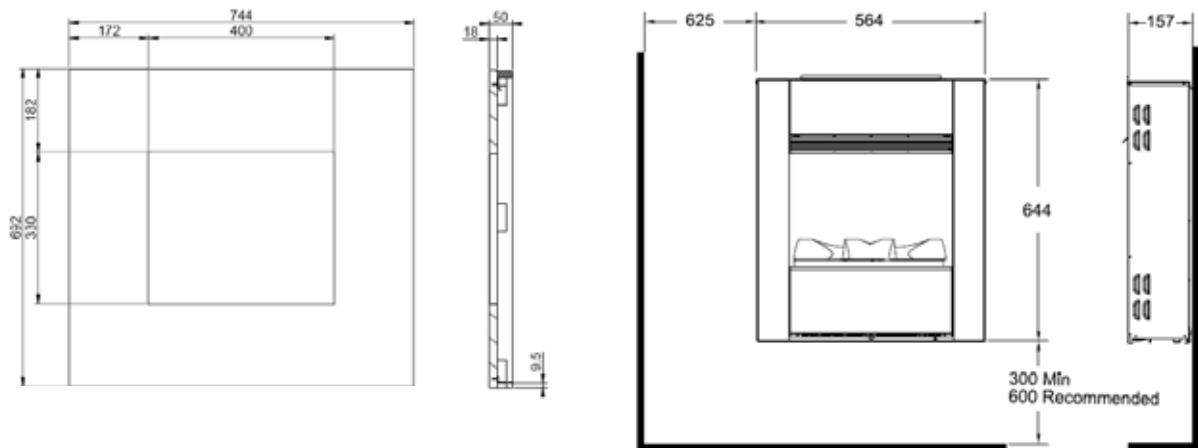

		Nissum concrete S	Nissum concrete L
General specifications	Fire system		
	Article number	207821	207838
	EAN code	5011139207821	5011139207838
	Model	Wall model	Wall model
	View of the fire	1 sided	1 sided
	Colour	Concrete look	Concrete look
	Decoration / fuel bed		
Product size	Measurements view of the fire (WxH)	40 x 32 cm (only if the engine is integrated)	54 x 32 cm (only if the engine is integrated)
	Outside dimensions WxHxD	74 x 69 x 6 cm (20 cm complete product)	88 x 69 x 6 cm (20 cm complete product)
Features	Heat output	-	-
	Thermostat	-	-
	Remote control	-	-
	Manual controlling directly at the fireplace possible yes / no	-	-
	Light module	-	-
	Sound module	-	-
	Colour effects settings	-	-
Power consumption	Heat setting 1 in W	-	-
	Heat setting 2 in W	-	-
	Flame only operation in W	-	-
	Max. consumption	-	-
Voltage	Voltage/Electrical frequency	-	-
Specifications	Product weight in kg	6	6,5
	Length of the cord	-	-
	Warranty	2 year	2 year