



e-MatriX

 **faber**

e-MatriX serie | 2019/2020 



Around a fire

Stories just keep coming

Together around the fire, familiar, comfortable. A good glass of wine, some nice music, the warmth around you, the light of the dancing flames. The stories come automatically. About what happened to you during the day, developments at work, news from friends and family. The stories from your past and your big dreams for the future. Things you don't usually share with others but that come so easy now, enveloped by warmth and trust. That's what a fire does to a person! Traditionally, fires were lit to keep the outside world at a distance. It's why a fire creates an atmosphere of intimacy and contact, where you listen to each other's stories.

A fire connects

Around a fire you share your holiday experiences with your friends, you tell your children a bedtime story, and you share your most intimate feelings with your loved one.

A look is all you need, and together you enjoy peaceful silence, gazing at the flames, because you don't need words to understand each other. The fire of love, where better than in front of an open fire? That is where you experience your most beautiful moments and when you take time for each other. That is where you share your stories, full of passion and full of fire!

There is **so much to tell...**



Faber means **175 years of quality**

The connective and soothing effect of an open fire is our passion. We are always looking for the best and most beautiful solutions, because we want our connoisseurs to enjoy an astonishing flame effect.

We strive for the same warmth and urge for quality in our contact with those around us. Our fires have been developed and produced in the Netherlands for devotees all over the world for more than 175 years. Today, Faber is part of the Irish family business Glen Dimplex, market leader in top-quality ambient electric fires. A strong and trusted combination, with a pure origin!

In the vanguard of the fire of the future

Faber's 'fire makers' are driven to produce the most beautiful ambient fires. Rooted in log fires, leading in gas fires and in the vanguard of fires with new fuels, such as biopropane, propane and water mist. With pure craftsmanship, knowledge and advanced technology, Faber is responsible for discoveries and patents that have become standard in the world of fires today. Our latest series of fires, the 'e-MatriX', uses water and electricity and is equally innovative. In short, 'making' ambient fires is part of Faber's DNA, and our pride and passion!

Your Faber fire built especially for you

If you choose a Faber, we build, adjust the settings and check the fire specifically for you. You can be certain that you have a characteristic Faber fire effect and a fire that operates perfectly and safely.



e-MatriX - **astounding fire... from water**

Modern houses generally need very little additional heat. A log fire is often not an option or unwanted. Building without gas is a current topic. We increasingly live in urban areas, where flue gases cannot always be discharged. The unique properties of the Faber e-MatriX make it possible to enrich your home with a splendid fire!

The fire experience is down to a combination of rising cold-water mist and special LED lights. You can even hear the crackling sound of a fire. Always different, fascinating and convincing... Just what you expect from a real log fire, but without the traditional restrictions and limitations!

Inspirational and 'future-proof'

The e-MatriX does not produce heat, which means it has zero impact on heating and climate-control systems. You don't need a gas connection, a flue-gas pipe or heat-resistant insulation. Emissions are nil too. Building regulations for using a gas or log fire do not apply, making it much easier to inset than gas or log fires and it creates room for ground-breaking design. These fires can be incorporated pretty much anywhere at all! What about the energy consumption? Minimal! Without the optional heat function, the energy consumption of the e-MatriX is comparable to ordinary room lighting. The tap-water consumption remains limited to just a few litres per 24 hours when in use.

A pleasant and healthy climate

The water mist that is produced contributes to healthy humidity in your home. As the glass window is not hot, the e-MatriX is safe to touch. The e-MatriX can be finished with a small, silent heating unit for a comfortable warm glow.



Faber e-MatriX series

for a fire that suits you

The e-MatriX series offers the best of Faber. As the name 'MatriX' suggests, there is maximum freedom of choice to create the fire that fits your personal taste and interior décor. At the same time, you can count on the best quality that Faber has to offer. For fans of open fires who want to add maximum value to their interior décor and living environment.

Create your own fire

The e-MatriX series is 'modular' in composition, so you have step-by-step options for dimensions, the numbers of sides to experience the fire, the decoration, the finish and more.

The Faber specialist is there for you throughout the entire process!

Did you find your favourite Faber fire? It will be built, set and tested by Faber, specifically for you, before we deliver it to the Faber specialist who will install it in your home.



A Faber e-MatriX fire you create yourself

Whatever your preference may be, you always have our enchanting, patented fire effect; fire that fuels the stories people tell each other. Our modular program consists of several models, formats and decoration options.

Model options

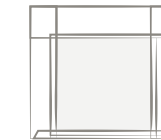

Front model

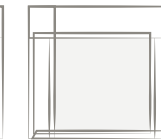

Two-sided model

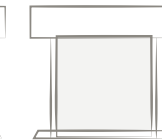

Three-sided model

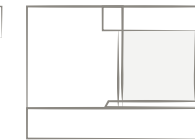

Room divider

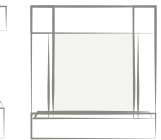

See-through model

Decoration option



Log set



Large log set

Heat option

If you'd like some extra heat from the fire, there is an optional small, silent heating unit for the e-MatriX. When you wish, comfortable heat flows to you through the glass. A sensation that makes the experience even more complete.



A Faber e-MatriX fire suits any interior

Interior-design trends

Faber tracks the current interior design trends and developments in detail. This is reflected in our photography and the current trend information in this brochure. It shows how a Faber fire fits in your modern, classic or bohemian interior.

The Faber specialist will be pleased to assist!

Are you considering enriching your home with a Faber fire? Would you like an inspirational design that suits all your wishes and requirements? Faber has a network of selected fire specialists who are here to help. Committed and experienced enthusiasts who are familiar with the possibilities of Faber fires, and who have various Faber models on display. They are keen to advise and like to consider how you can translate your personal wishes into an appealing and attractive interior design. They also deal with professional installation. Check the Faber website for a Faber specialist near you.

Interior-décor style

Vital Vibe

This contemporary, urban style brings outdoor life into the home, with natural wood, graphical minimalism and an abundance of greenery. An environmentally aware and relaxed way of life where you feel at home straight away.

e-MatriX | 800/500 |

Also available on gas, propane and biopropane



PANTONE® 7535C	PANTONE® WHITE OPTIC	PANTONE® 465C	PANTONE® 487C	PANTONE® 604C	PANTONE® 7749C
-------------------	----------------------------	------------------	------------------	------------------	-------------------



Interior-décor style

Sassy Style

This style refers to the 1950s with its classy, rich emotion in graphical shapes, velvety furnishings and bright colours. The decoration is vintage or bohemian and creates a free-spirited sensation.

e-MatriX | 800/500 II

Also available on gas, propane and biopropane

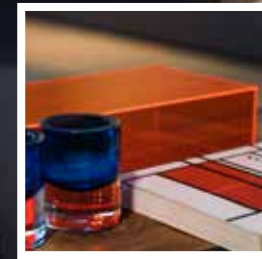

Interior-décor style

Colonial Chic

This orientally influenced theme intrigues the eye with different woods, water plant prints and tropical furniture. An attractive, mystical oasis for the discerning mind.

e-MatriX | 800/500 III

Also available on gas, propane and biopropane

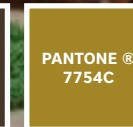
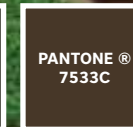
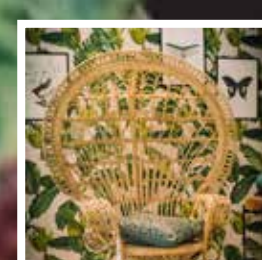
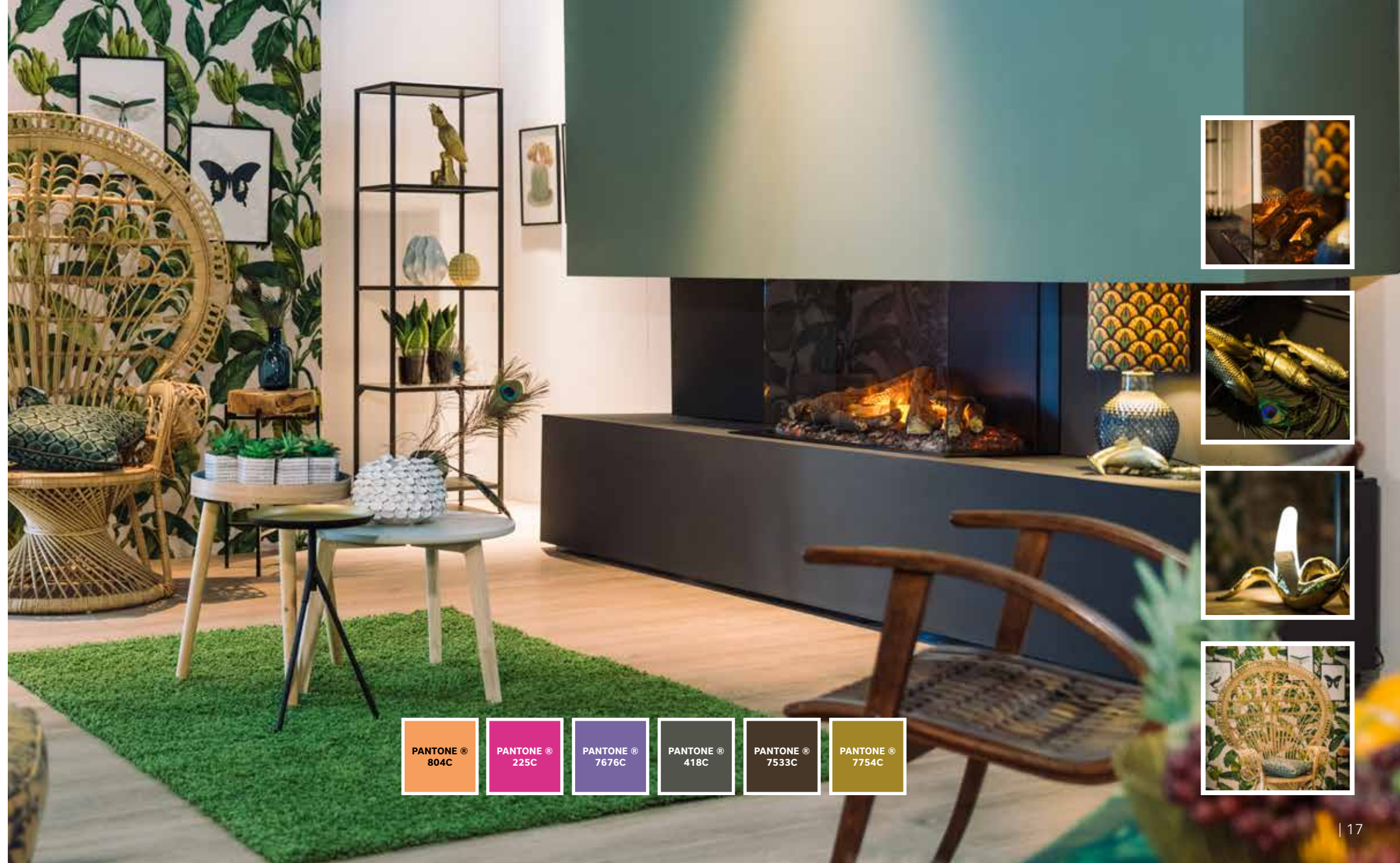

Interior-décor style

Delicate Desire

This contemporary style is characteristically modern with pure lines and geometric shapes. Lots of light, with pastel colours, warm and light fabrics, and a feel for nature.

e-MatriX | 800/500 RD

Also available on gas, propane and biopropane



PANTONE®
9262C

PANTONE®
9080C

PANTONE®
2373C

PANTONE®
7542C

PANTONE®
7518C

PANTONE®
422C

Interior-décor style

Delicate Desire

This contemporary style is characteristically modern with pure lines and geometric shapes. Lots of light, with pastel colours, warm and light fabrics, and a feel for nature.

e-MatriX | 800/500 ST

Also available on gas, propane and biopropane



PANTONE®
9262C

PANTONE®
9080C

PANTONE®
2373C

PANTONE®
7542C

PANTONE®
7518C

PANTONE®
422C



Safe harbour

“As a doctor I travel the world. When I return home after a longer period of time, I’m struck by the stark differences. Their standard of living is in shrill contrast to our material world. At home in front of the fire I can reconnect with myself.”

e-MatriX | 800/650 |

Also available on gas, propane and biopropane



e-MatriX | 800/650 II

Also available on gas, propane and biopropane



Working from home

"We were forced to make a major change to our lives. So we jumped in at the deep end and started an online shop. We turned our passion into our job. Our living room now doubles up as our office.

Sometimes we switch off our computers on purpose. A little quality time in front of the fire."

e-MatriX | 800/650 III

Also available on gas, propane and biopropane





e-Matrix Burner

A complete flame effect



The astonishing flame effect is down to a combination of rising cold-water mist and special LED lights. The result is a playful, three-dimensional fire effect that moves up from the softly glowing ash bed between the logs to the top of the fire. The ash bed itself radiates a warm red glow because of a glow module that works on low-energy LEDs. You can even hear the sound of a crackling fire. An ultra-thin flexible water hose and a regular socket are enough for the connection.

Additional heating unit - wonderful heat in front of the fire

Are you sitting near the fire and you'd like to feel the radiating warmth? There is an optional compact, silent heating unit for the e-Matrix that is incorporated invisibly in the fireplace. When you want, a warm air flow comes your way through the glass. A sensation that makes the experience even more complete. This additional heating unit has a capacity of maximum 2 kW and a thermostat function. The operation is integrated into the remote control.

e-MatriX fires

	Page	DIMENSIONS		BURNER	DECORATION		
		Exterior dimensions WxHxD in mm*	Fire display WxHxD in mm	e-MatriX burner	Logs	Log set with large logs	Glowing em- bers lighting
e-MatriX 800/500 I	12	891 x 790 x 517	800 x 500	●	●		●
e-MatriX 800/500 II	14	934 x 790 x 517	822 x 500 x 351	●	●		●
e-MatriX 800/500 III	16	995 x 790 x 516	843 x 500 x 351	●	●		●
e-MatriX 800/500 RD	18	1000 x 804 x 549	822 x 500 x 396	●	●		●
e-MatriX 800/500 ST	20	946 x 805 x 548	800 x 500	●	●		●
e-MatriX 800/500 RD	18	1000 x 804 x 549	822 x 500 x 396	●		●	●
e-MatriX 800/500 ST	20	946 x 805 x 548	800 x 500	●		●	●
e-MatriX 800/650 I	22	891 x 940 x 517	800 x 650	●	●		●
e-MatriX 800/650 II	24	934 x 940 x 517	822 x 650 x 351	●	●		●
e-MatriX 800/650 III	26	995 x 940 x 552	843 x 650 x 351	●	●		●

*The versions with a heat option are 32 mm taller

For more information, please take a look at the website www.faber-fires.eu

HEATING	INTERIOR	SOUND	CONTROLLER	
Heat element	Back wall smooth steel	Sound module	Remote control	Bluetooth remote control
Optional	●	●	●	●
Optional	●	●	●	●
Optional	●	●	●	●
Optional	●	●	●	●
Optional	●	●	●	●
Optional	●	●	●	●
Optional	●	●	●	●
Optional	●	●	●	●
Optional	●	●	●	●
Optional	●	●	●	●

Maximum 2 kW heat output produces comfortable additional heating for a room of maximum 30m²

The options per fire produce an additional cost.

Line drawings

e-Matrix | 800/500 I

Page 12

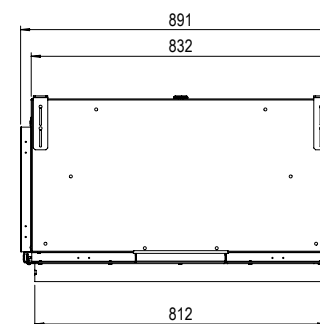
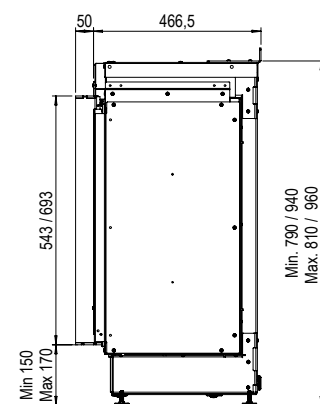
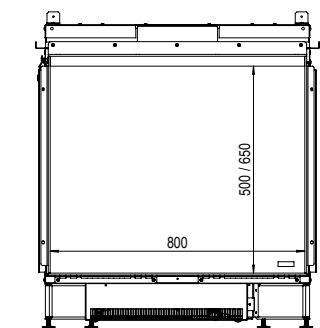

e-Matrix | 800/500 II

Page 14

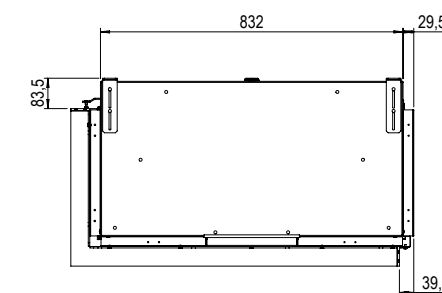
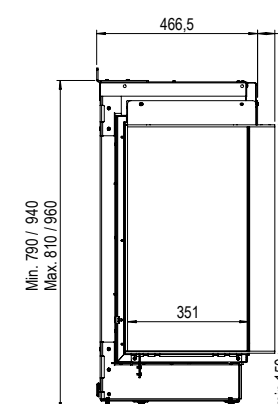
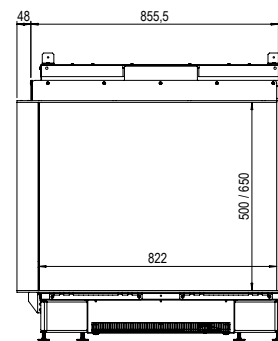

e-Matrix | 800/500 III

Page 16

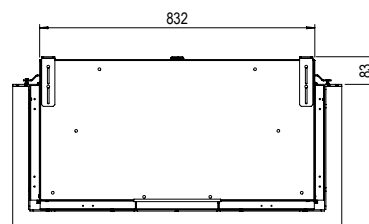
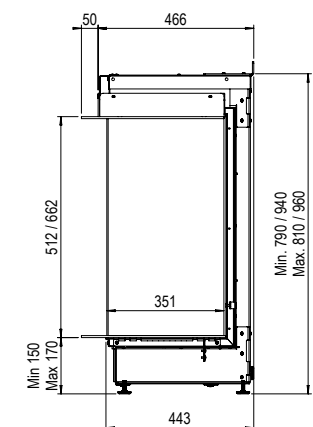
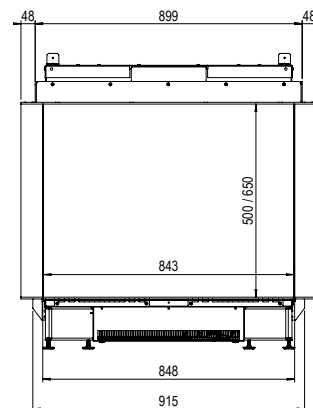

e-Matrix | 800/500 RD

Page 18

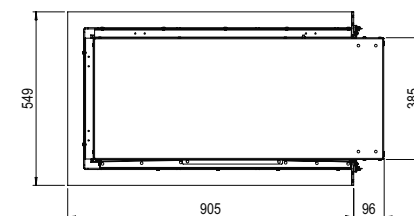
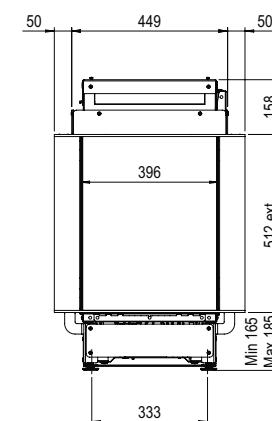
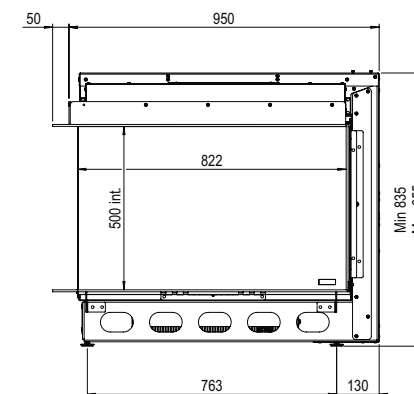

e-Matrix | 800/500 ST

Page 20

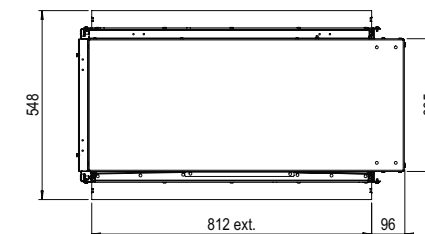
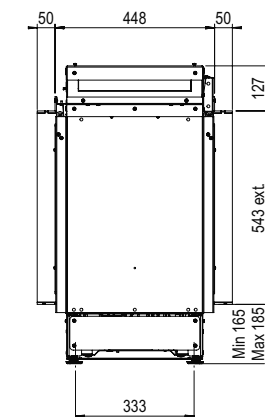
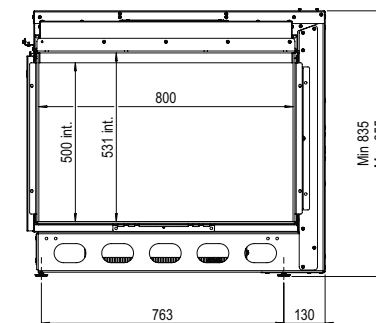

For the e-Matrix series, whilst stocks last, the fire casing may be 32mm lower than noted on the drawings in these brochures. After delivery, check the height of the fire casing to prevent misunderstandings.

The very latest drawings of Faber fires are available on the website www.faber-fires.eu.

Line drawings

e-MatriX | 800/650 I

Page 22

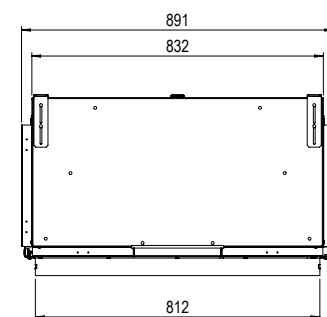
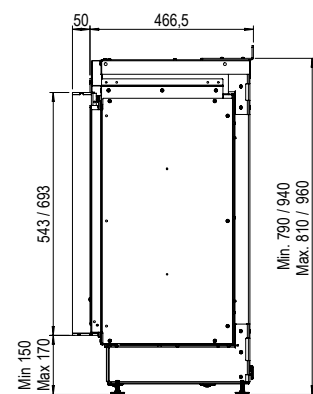
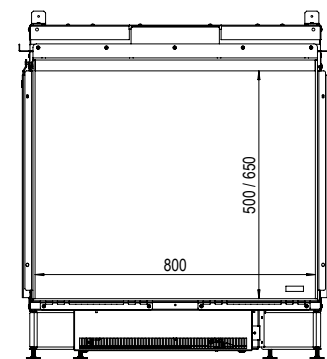

e-MatriX | 800/650 II

Page 24

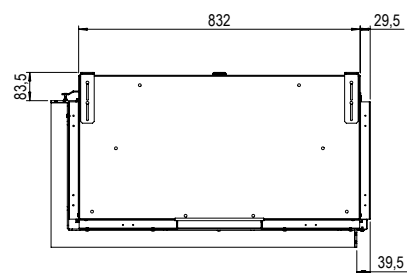
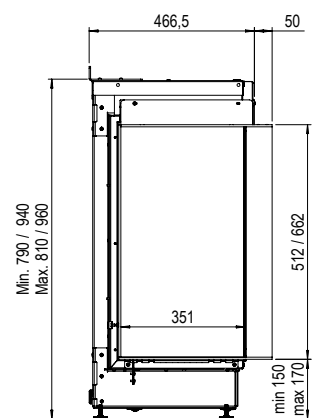
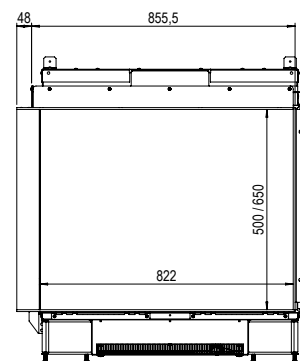

e-MatriX | 800/650 III

Page 26

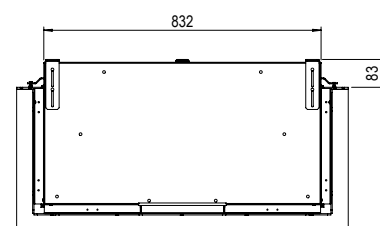
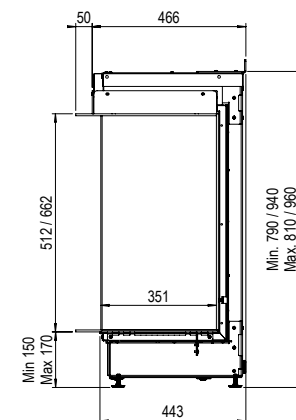
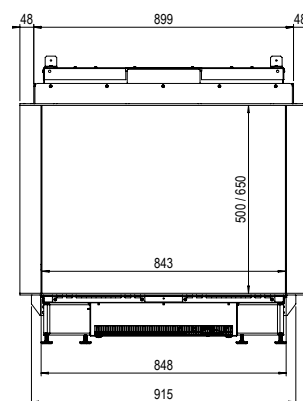

Draw a dream fire

in your own home

Measurements provide knowledge!

Would you like to know the exact dimensions of our inset fires and stoves? Our dimensions drawings are in this brochure or on our website www.faber-fires.eu.

You can also find our fires in the design programmes 'SketchUp' or PaletteCad. Convenient when you want to draw on your own inspiration! <https://www.sketchup.com/> and https://www.palettecad.com/en/home_2

The Faber dealer, who can be found on www.faber-fires.eu, will help you to realise your design.

Other Faber collections:



Matrix serie - gas fires



Free standing - gas fires



Gas built in - gas fires



Outdoor - gas fires

Your dealer:

Disclaimer

We have produced this publication with the greatest possible care. However the information, including drawings, in this publication may be represented incorrectly, it may have changed or been supplemented. This publication is subject to change. Glen Dimplex Consumer Appliances Europe is not responsible for the consequences of actions, decisions or results that are solely based on the information in this publication. We emphasise that the correct installation and safe operation should be in accordance with the applicable rules and regulations, the manual, and the expertise and advice of an expert. The photos in this publication only represent examples of possible configurations. Whilst stocks last. Our terms and conditions of delivery are available upon request.

faber

Saturnus 8, NL-8448 CC Heerenveen
PO Box 219, NL-8440 AE Heerenveen

t +31 513 656 500
e info@faber-fires.eu

faber-fires.eu

@faberhaarden



FaberInternational



Proud brand of

GlenDimplex
CONSUMER APPLIANCES EUROPE
EU FLAME