

EDEL 270 AIR DE/2

Heat pump water heater

using exterior air or non-heated ambient air

WITH THERMAL HEAT EXCHANGER



www.auer.fr

Supplemental installer manual

Edel 270 AIR DE/2

Ref. 353431

1 - Présentation

1.1 - Dimensions

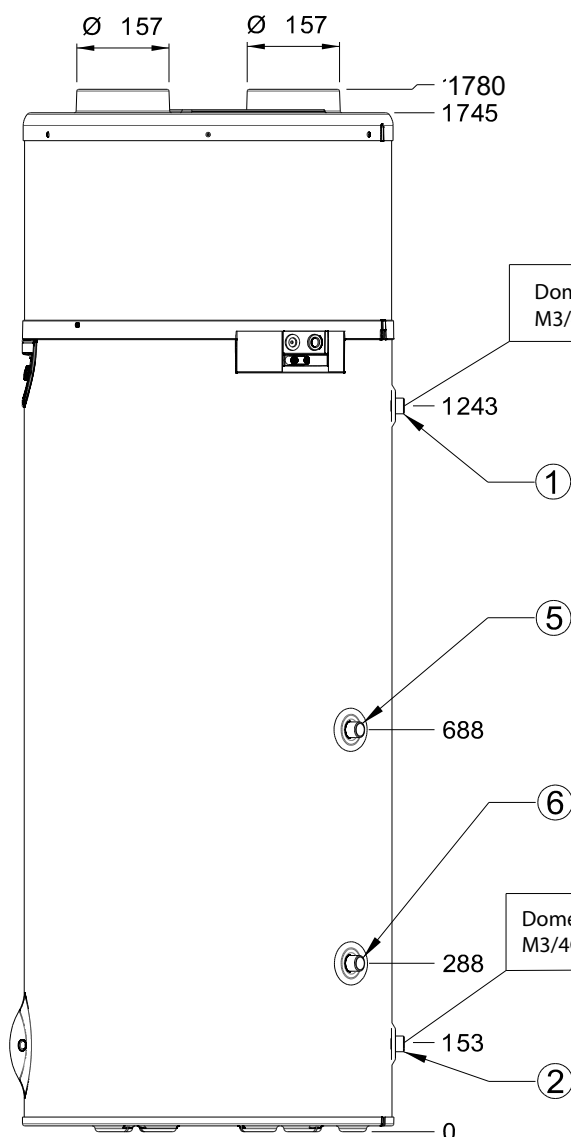

- ① - Domestic Hot Water outlet (DHW) 3/4"
- ② - Domestic Cold Water inlet (DCW) M3/4"
- ③ - Air exhaust Ø160
- ④ - Air intake Ø160
- ⑤ - Heat exchanger inlet M3/4" (Max. temperature = 95°C)
- ⑥ - Heat exchanger outlet M3/4"

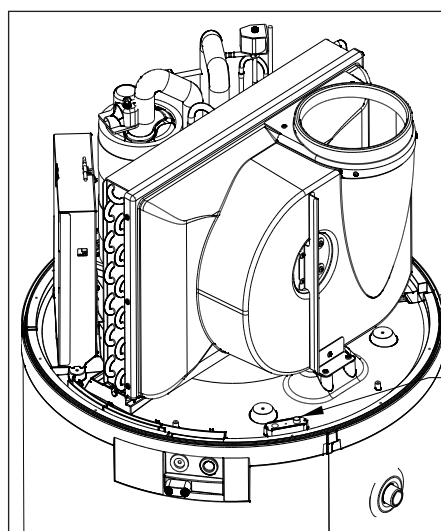

Bulb well for domestic water sensor

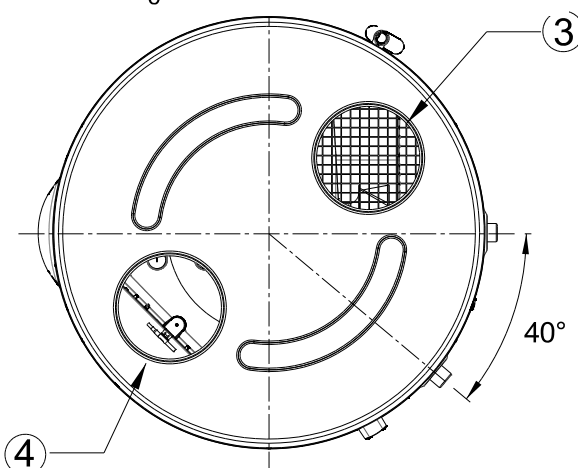

French
manufacturer



Manual ref : 1897131
Edition n° 19.296

2.3 - Electrical connection with primary heat exchanger for coupling to a boiler

HP - High pressure - pressure switch
 C15 - Compressor start-up capacitor
 C2 - 1,5μF fan capacitor
 C4 - 4μF fan capacitor
 EV - De-icing valve
 RE - 1500W electrical resistance
 LTS - Electrical back-up temperature limiting safety thermostat
 AqL - Electrical back-up safety aquastat
 PHP - High pressure - pressure switch

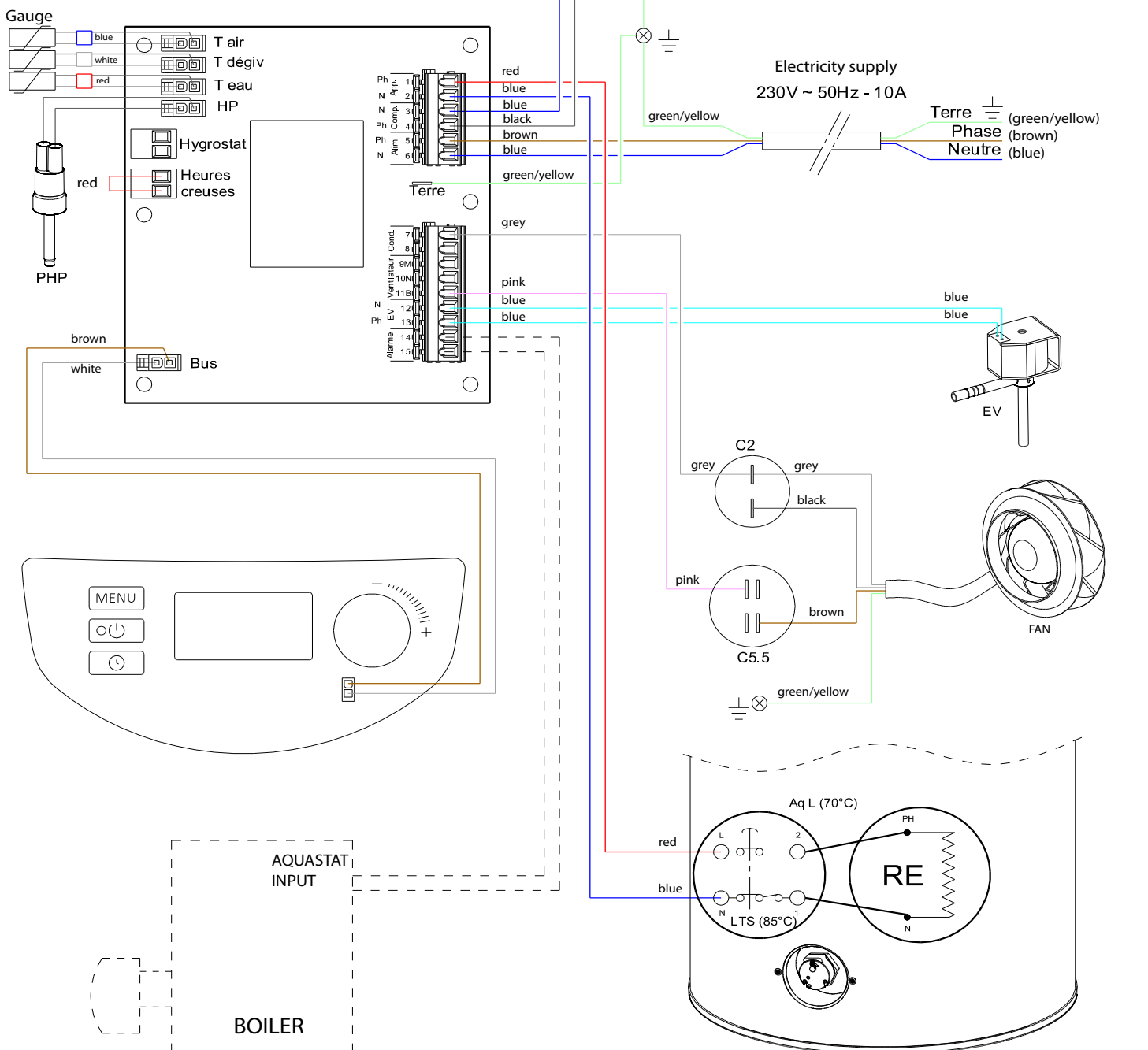

2.4 - Changing the fan speed

If the heat pump water heater is connected using pipes, it is necessary to adjust the fan speed to allow for the heat pump to overcome heat losses caused because of the air connections.

Changing of the fan speed can be done using the electrical terminal of the appliance.

The grey wire must be moved (connecting the 11B output on the circuit board to the 5,5µF capacitor) to the double input on the 5,5µF capacitor which already contains the blue wire for the fan.

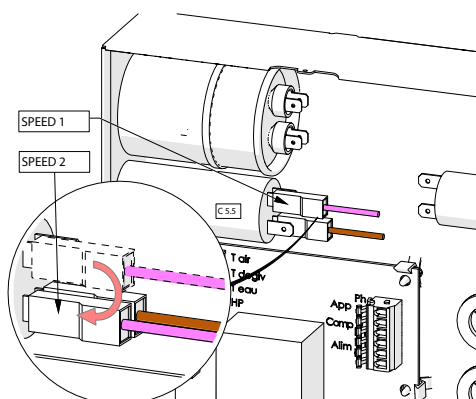

2.4 - User menu: choice of back-up boiler

Direct access by pressing the «Menu» button.
Turn the dial to scroll through the user menu options.

TEMP. WATER

Setting the water temperature

HOLIDAY

Programming holiday mode

BOOST

Activation of the Boost function

BACKUP

Choice of back-up

then

BACKUP

- Press on the dial to access the back-up options

ELECTRIC

- Turn the dial to change the back-up

or

BOILER

- Press on the dial to confirm your selection.

Note : The symbol  or  will appear depending on the back-up chosen.



Industrial and development site
Rue de la République
CS 400239
80210 Feuquières-en-Vimeu

Spare parts department

Tel: 03 22 61 21 21 - Fax: 03 22 61 33 35
E-mail: pieces@auer.fr

Technical assistance department*

E-mail: enr@auer.fr

**Technical assistance is reserved for professionals*